

Client Project Case Study:

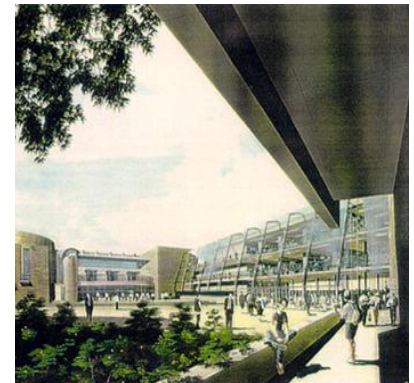

Title of Project:	New Medical School at the NRIE
Thomson Bethune's Role:	Cost Management and Due Diligence
Client Sector:	Public - Health
Client:	University of Edinburgh
Project Cost:	£23M
Location:	Edinburgh, Scotland

Project Scope:	
Background to the project:	Construction of a new medical school faculty building within the overall PFI proposals within the New Royal Infirmary of Edinburgh. The building comprises accommodation comprising teaching facilities, lecture theatres, laboratory accommodation, faculty administration accommodation, library and undergraduate, post graduate facilities.
The value Thomson Bethune added to this project:	Thomson Bethune duties were: Compilation of feasibility cost plan; Submission to Public Sector Comparator calculations to Scottish Office and SHEFC; Party to Outline and full Business Cases to Scottish Office; Calculation of Life Cycle costs and negotiation with Consortium; Liaison and discussions with Scottish Office and SHEFC; Evaluation of PFI tenders and negotiation with consortium; Assisting UoE Lawyers and Accountants with regard to Legal and Contractual issues.

Contact Thomson Bethune:	
If you would like to speak to a member of the Thomson Bethune team, simply call our office or send us an email and a member of the Thomson Bethune team will contact you directly.	<p>Edinburgh Office: Tel: 0131 220 1828 info@thomsonbethune.co.uk</p> <p>Glasgow Office: Tel: 0141 221 7365 info@thomsonbethune.co.uk</p>