

Client Project Case Study:

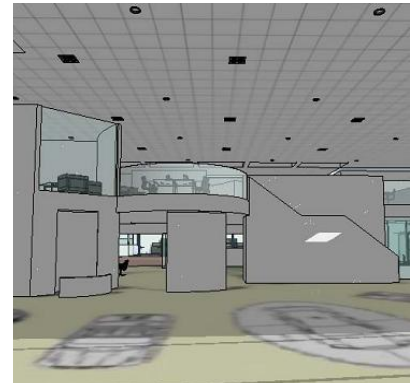

Title of Project:	Proposed Toyota Car Showroom
Thomson Bethune's Role:	Cost Management and CDM Coordination
Client Sector:	Commercial
Client:	Eastern Properties (Scotland) Ltd
Project Cost:	£3.4M
Location:	Edinburgh, Scotland
Date:	December 2010 – November 2011

Project Scope:	
Background to the project:	Eastern properties require a new Toyota dealership centralised within a new business park in close proximity to existing showrooms owned by the group.
The value Thomson Bethune added to this project:	Thomson Bethune will undertake traditional Quantity Surveying services including preparation of cost plans, bills of quantities for work packages, prepare tender reports, contract awards, formalisation of contract documents, valuations and final accounting.

Contact Thomson Bethune:	
If you would like to speak to a member of the Thomson Bethune team, simply call our office or send us an email and a member of the Thomson Bethune team will contact you directly.	<p>Edinburgh Office: Tel: 0131 220 1828 info@thomsonbethune.co.uk</p> <p>Glasgow Office: Tel: 0141 221 7365 info@thomsonbethune.co.uk</p>